



Postal Address
PO Box 63
Riverside
Tasmania 7250
W 6ty.com.au
E admin@6ty.com.au

Tamar Suite 103
The Charles
287 Charles Street
Launceston Tasmania
P (03) 5332 3300

57 Best Street
Devonport Tasmania
P (03) 6424 7161

6ty Pty Ltd
ABN 27 014 609 900
Architectural
ABP No. CC4874f
Structural / Civil
ABP No. CC16333
Building Services Provider
ABP No. 311245120



ISO 9001
Certification Services

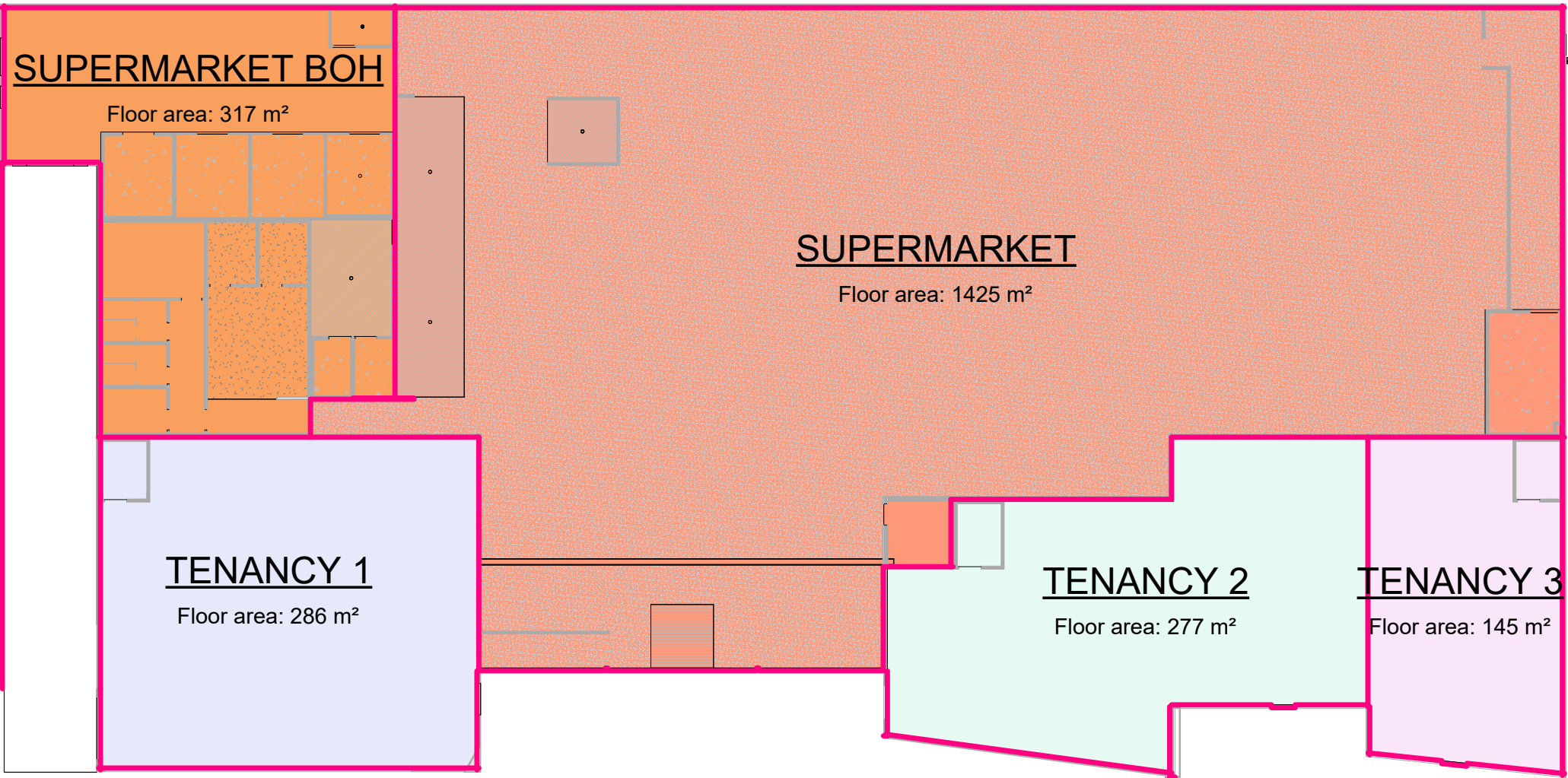

LETTABLE FLOOR AREA

SCALE 1 : 250

ISSUE	DATE	ISSUED FOR
001	29.03.23	TENDER

DIMENSIONS ARE IN MILLIMETRES. DO NOT SCALE. CHECK AND VERIFY ALL DIMENSIONS ON SITE. REFER DISCREPANCIES TO THE SUPERINTENDENT. ALL WORK SHALL BE CARRIED OUT IN ACCORDANCE WITH BUILDING CODE OF AUSTRALIA, APPLICABLE AUSTRALIAN STANDARDS AND LOCAL AUTHORITY REQUIREMENTS. COPYRIGHTS THIS DRAWING AND ALL OF ITS CONTENT REMAIN THE PROPERTY OF 6ty Pty Ltd. THE DRAWINGS AND ITS CONTENT MAY NOT BE RETAINED, COPIED OR REPRODUCED IN PART OR WHOLLY, WITHOUT THE WRITTEN PERMISSION FROM 6ty Pty Ltd. SOME SPECIFIED CONTENT, BRANDS AND MANUFACTURERS MAY BE COPYRIGHTED PROPERTY OF OTHERS. ACKNOWLEDGEMENT OF THESE COPYRIGHTS ARE HEREBY GIVE.

PROJECT: SUPERMARKET DEVELOPMENT
ADDRESS: 162 BRIGHTON ROAD BRIGHTON, TASMANIA
FOR: TASMANIAN INDEPENDENT RETAILERS

DRAWING: LETTABLE FLOOR AREA SKETCH PLAN

DESIGNED: L.P.B. DRAWN: L.P.B. CHECKED: -
SCALES: 1 : 250

PROJECT No: 21.014 DRAWING No: As05 REV: 001



PROJECTION NORTH